



FB-FirePAC® Standard Termination Panel (STP) 8800-STP-16PD Power Distribution



Overview

FB-FirePAC is a Protected Premises Control Unit and Combination System that is NRTL tested and approved to meet ANSI / UL-864 10th Edition and various other UL & NFPA codes as required by this standard.

The FireBus Power Distribution Standard Termination Panel (8800-STP-16PD) is designed specifically for the FB-FirePAC series of Fire Alarm Control Units (FACU).

This Standard Termination Panel (STP) is completely passive with the exception of a Power On LED.

STP AC Power Circuit

The AC Power circuit of the STP allows for the incoming AC source to be landed, provides an ON/OFF switch¹ and a terminal block to feed power to a power supply module in the FB-FirePAC or FB-PowerBoost system.

- Three position "AC Power In" terminal block, up to 14 AWG wire for connecting the outside power source.
- Power switch allowing AC power to be removed from the power supply module to test battery backup system.
- Three position "AC to Power Supply" terminal block, factory wired into the power supply module.

STP DC Power & Charging Circuit

The DC Power circuit of the STP has a green DC power indicating LED and three sets of two position terminals interfacing to the power supply module and battery bank.

- Power supply and battery terminals support up to 10 AWG wire.
- A "Battery Connection" double high terminal block with the lower two terminals connecting to the power supply modules battery charger circuit and the upper two terminals connecting to the battery bank.
- A two position "24 VDC Input" providing power to the 24 VDC Bridge.

¹ A mechanical detent is provided to reduce the probability of accidentally toggling the switch.

STP 24 VDC Bridge

The 24 VDC Power Distribution Bridge provides an 18 circuit buss arranged in two rows in a dual height terminal block package. The 24 VDC (+) Positive being the lower height row and the 24 VDC (-) Negative (DC Common) being the upper height row.

These terminals are used to feed secure battery backed 24 VDC power to various components within the FB-FirePAC system.

- 24 VDC Bridge terminals to power system components supporting up to 14 AWG wiring.
- Green LED shows when power is being supplied to the power distribution bridge.

Operation

The STP routes AC power from the "AC Power IN" terminal block, through an ON/OFF switch and out the "AC to Power Supply" terminal block where it is factory wired to the input of the power supply module.

24 VDC power from the power supply module enters the STP at the "24 VDC Input" terminal block and feeds the 24 VDC Bridge. A green LED indicates 24 VDC is present and being fed to the bridge.

Factory wiring connects the power supply modules battery charger output to the input of the STP marked "Battery Connection" through the lower set of terminals. The upper set of terminals connects to the battery bank to charge the batteries under normal conditions or to feed battery power to the power supply module under a loss of AC power condition.

<p>Power Distribution Term. Panel Part No 8800-STP-16PD</p> <p>Control Platform: FB-FirePAC on the 1756 ControlLogix Platform</p> <p>Designed for use with the FB-FirePAC 1864-FBD-8104 Power Supply / Charger</p> <p>Software Compatibility: Not Applicable</p> <p>Device Configuration: None</p>	<p>Operating voltage: 18–30 VDC</p> <p>Communication protocols: None</p> <p>Current (24 vdc): This module is “passive” and current is determined by the Power Supply / Battery Charger module.</p>	<p>EMI/RFI compatibility: Not Applicable, No active electronic components</p> <p>Temperature range: Max. continuous operating 158°F (70°C) Min. continuous operating -4°F (-20° C) (no condensation/icing)</p> <p>Storage -40°F to +176°F (-40°C to +80°C)</p> <p>Humidity: 5 to 95% relative humidity (no condensation)</p>	<p>Approvals: Control Units and Accessories For Fire Alarm Systems [UL 864:2014 Ed. 10]</p> <p>Location rating: Class I, Div. 2, Groups B,C,D (Pending)</p> <p>4.094 in (104 mm) Wide 3.634 in (92.3 mm) High 2.868 in (72.9 mm) (Deep)</p> <p>Weight: 8.0 oz (226.8g)</p> <p>Materials: ROHS compliant</p>
---	---	---	--

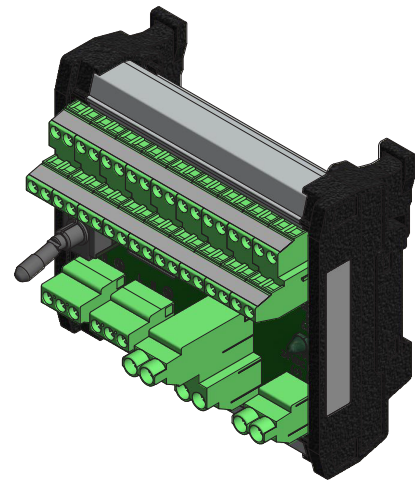
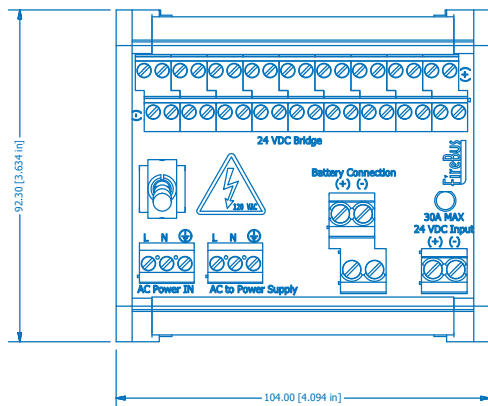
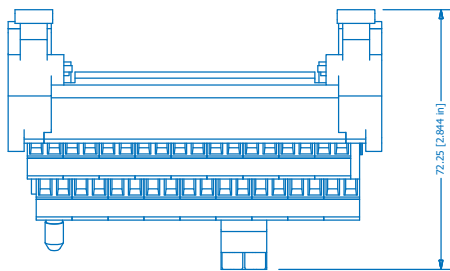

Ordering information:

8800-STP-16PD Standard Term. Panel, Power Distribution